

STAINLESS STEEL RISING STEM GLOBE VALVE

SS304 200PSI F3S200R-50
 SS316 200PSI F3S200R-51



FEATURES & SPECIFICATIONS

- Threaded bonnet
- Swivel disc
- Rising stem
- Full bore design
- Threaded to ANSI B2.1 / BS21 / DIN 259 / DIN 2999
- Applicable for Building Services, Air-Conditioning, Fire-Protection, Cold Water Plumbing, Hot Water System, General Industries

PRESSURE & TEMPERATURE RATINGS

Working Pressure	200psi WOG Non-Shock
Shell Test Pressure	x1.5 times
Seat Test Pressure	x1.1 times
Working Temperature	-25°C ... 180°C
Suitable Media	Water, Oil & Gas



MATERIAL SPECIFICATIONS

Part	Material	Specification
Body	Stainless Steel 304	EN 10088-3 1.4301
	Stainless Steel 316	EN 10088-3 1.4401
Disc	Stainless Steel 304	EN 10088-3 1.4301
	Stainless Steel 316	EN 10088-3 1.4401
Stem	Stainless Steel 304	EN 10088-3 1.4301
	Stainless Steel 316	EN 10088-3 1.4401
Cap	Stainless Steel 304	EN 10088-3 1.4301
	Stainless Steel 316	EN 10088-3 1.4401
Seal	PTFE	
Gasket	Stainless Steel 304	EN 10088-3 1.4301
Packing	PTFE	
Handwheel	Cast Iron	

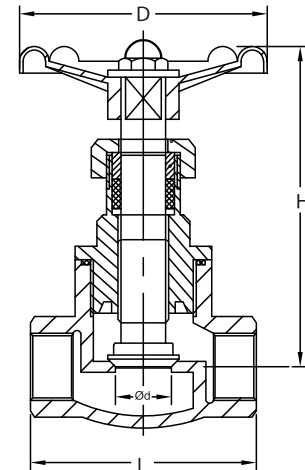

DIMENSIONS

DN (mm)	6	10	15	20	25	32	40	50	65	80	(mm)
DN (inch)	¼	⅜	½	¾	1	1¼	1½	2	2½	3	
L	55	55	67	75	85	101	115	136	165	190	
H	79	79	79	91	106	125	136	146	177	197	
D	65	65	65	77	77	97	97	97	126	126	

Fivalco® is Registered Trade Mark
FIVALCO LIMITED
 info@fivalco.com | www.fivalco.com

Exclusive Distributor :
ENVALCO SDN. BHD. (1039097-M)
 No. 30, Jalan PJU 3/46, Sunway Damansara Technology Park, 47810 Petaling Jaya, Selangor Darul Ehsan, Malaysia
 T: 603 - 7883 0018 | F: 603 - 7883 0012 | E: enquiry@envalco.com.my | W: www.envalco.com.my