

HIGHRISER SWING CHECK VALVE GROOVED ENDS

365PSI

Fig No.: 5201-365-GGI



DESCRIPTION

5201-365-GGI is a non-return valve which permits water flow in one direction and prevents flow in reverse direction. This function is realized by a broadened bronze seat, to provide a long service time and leak-free sealing. It is widely used with various configurations in fire pump room, fire sprinkler systems, fire department connections, gravity pressure tank or by-pass connections etc.



FEATURES & SPECIFICATIONS

- Swing type
- Fusion bonded epoxy coated RAL3002
- Grooved ends to suit ANSI / AWWA and BS Pipe size
- Working pressure : 365psi
- Working temperature : 0°C ... 80°C



MATERIALS LIST

Part	Specification
Body	Ductile Iron ASTM A536 65-45-12
Seat	Bronze ASTM B62 C83600
Clapper	Carbon Steel WCB Q235 + EPDM
Clapper Arm	Stainless Steel AISI 304
Washer	Stainless Steel AISI 304
Hexagonal Slot Thin Nut	Stainless Steel AISI 304
Split Pin	Stainless Steel AISI 304

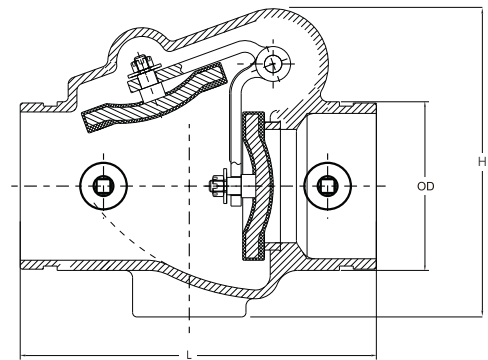

DIMENSIONS (inch/mm)

Size	2"/50	2.5"/65	3"/80	4"/100	5"/125	6"/150	8"/200	10"/250	12"/300			
L	6.65/169	7.99/203	8.39/213	9.65/245	10.54/267	11.50/292	14.02/356	17.01/432	19.49/495			
H	5.69/144.65	6.02/153	6.71/170.5	7.89/200.5	9.33/237	10.75/273	12.91/328	15.24/387	17.66/448.5			
OD	2.37/60.3	2.87/73	3.0/76.1	3.5/88.9	4.5/114.3	5.5/139.7	5.56/141.3	6.5/165.1	6.63/168.3	8.63/219.1	10.75/273	12.75/323.9

NET WEIGHT (kg) & CRATE QTY (pcs)

Size	2"/50	2.5"/65	3"/80	4"/100	5"/125	6"/150	8"/200	10"/250	12"/300
N.W.	3.5	4.5	6	9.5	18	19.5	33	53	94
Crate Qty	100	100	95	50	32	32	6	6	2

Fivalco® is Registered Trade Mark
FIVALCO LIMITED
 info@fivalco.com | www.fivalco.com

Exclusive Distributor :
ENVALCO SDN. BHD. (1039097-M)
 No. 30, Jalan PJU 3/46, Sunway Damansara Technology Park, 47810 Petaling Jaya, Selangor Darul Ehsan, Malaysia
 T: 603 - 7883 0018 | F: 603 - 7883 0012 | E: enquiry@envalco.com.my | W : www.envalco.com.my

HIGHRISER SWING CHECK VALVE GROOVED ENDS

365 PSI

Fig No.: 5201-365-GGP



DESCRIPTION

5201-365-GGP is a vertical installed non-return valve in a "Riser" arrangement. With trim unit, the check valve utilizes an electric flow switch and alarm bell instead of a water motor gong for fire notification. Valve body is the same as 5201-365-GGI, easy to adapt on job field.

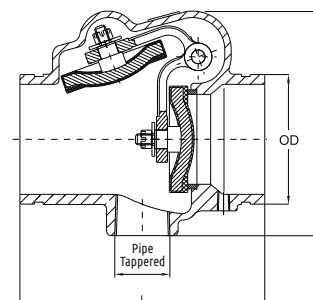
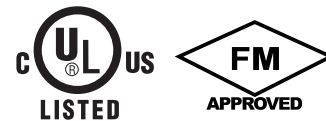

FEATURES & SPECIFICATIONS

- Swing type
- Fusion bonded epoxy coated RAL3002
- Grooved ends to suit ANSI / AWWA and BS Pipe size
- Working pressure : 365psi
- Working temperature : 0°C ... 80°C

MATERIALS LIST

Part	Specification
Body	Ductile Iron ASTM A536 65-45-12
Seat	Bronze ASTM B62 C83600
Clapper	Carbon Steel WCB Q235 + EPDM
Clapper Arm	Stainless Steel AISI 304
Washer	Stainless Steel AISI 304
Hexagonal Slot Thin Nut	Stainless Steel AISI 304
Split Pin	Stainless Steel AISI 304

PIPE TAPERED THREAD SIZE TABLE

Nominal Size (inch/mm)	Pipe Tapered Standard Thread Size	Pipe Tapered Optional Thread Size
2/50	1"	0.25", 0.5", 0.75"
2.5/65	1.25"	0.25", 0.5", 0.75", 1"
3/80	1.25"	0.25", 0.5", 0.75", 1"
4/100	2"	0.25", 0.5", 0.75", 1", 1.25", 1.5"
5/125	2"	0.25", 0.5", 0.75", 1", 1.25", 1.5"
6/150	2"	0.25", 0.5", 0.75", 1", 1.25", 1.5"
8/200	2"	0.25", 0.5", 0.75", 1", 1.25", 1.5"
10/250	2"	0.25", 0.5", 0.75", 1", 1.25", 1.5"
12/300	2"	0.25", 0.5", 0.75", 1", 1.25", 1.5"

Note: Pipe tapered thread hole size has to be specified by ordering. If non-standard thread, please contact Fivalco or its local distributor.

DIMENSIONS (inch/mm)

Size	2"/50	2.5"/65	3"/80	4"/100	5"/125	6"/150	8"/200	10"/250	12"/300			
L	6.65/169	7.99/203	8.39/213	9.65/245	10.54/267	11.50/292	14.02/356	17.01/432	19.49/495			
H	5.69/144.65	6.02/153	6.71/170.5	7.89/200.5	9.33/237	10.75/273	12.91/328	15.24/387	17.66/448.5			
OD	2.37/60.3	2.87/73	3.0/76.1	3.5/88.9	4.5/114.3	5.5/139.7	5.56/141.3	6.5/165.1	6.63/168.3	8.63/219.1	10.75/273	12.75/323.9

NET WEIGHT (kg) & CRATE QTY (pcs)

Size	2"/50	2.5"/65	3"/80	4"/100	5"/125	6"/150	8"/200	10"/250	12"/300
N.W.	3.5	4.5	6	9.5	18	19.5	33	53	94
Crate Qty	100	100	95	50	32	32	6	6	2

Fivalco® is Registered Trade Mark
FIVALCO LIMITED
 info@fivalco.com | www.fivalco.com

Exclusive Distributor:
ENVALCO SDN. BHD. (1039097-M)
 No. 30, Jalan PJU 3/46, Sunway Damansara Technology Park, 47810 Petaling Jaya, Selangor Darul Ehsan, Malaysia
 T: 603 - 7883 0018 | F: 603 - 7883 0012 | E: enquiry@envalco.com.my | W: www.envalco.com.my