

# HIGHRISE BUTTERFLY VALVE LUG TYPE

## 300PSI

## Fig No.: FPBG-300L

### FEATURES & SPECIFICATIONS

- Valve conforms to MSS SP-67 / BS EN593: 2009
- Design and test standard conforms to FM1112 and UL1091
- Fusion bonded epoxy coated RAL3002
- Fitted with visual indicator and supervisory switch
- EPDM encapsulated disc
- Valve suitable for indoor and outdoor installation
- Lugged connection to ANSI Class 150 / BS 4504 PN16 / EN 1092-2 PN16
- Working pressure : 300psi - Non Shock Coldwater  
Max. Test Pressure : 600psi
- Working temperature : -10°C ... 120°C

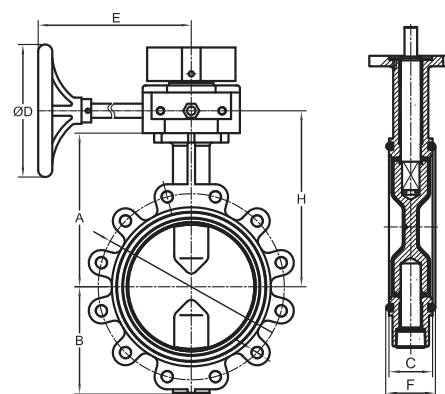
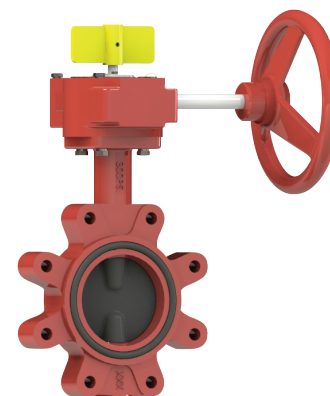
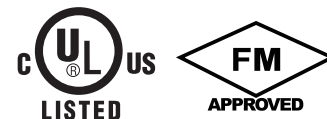

### MATERIALS LIST

Name	Material
Body	Ductile Iron ASTM A536 65-45-12
Disc	Ductile Iron ASTM A536 65-45-12 + EPDM
Lower Shaft	Stainless Steel SS410
Upper Shaft	Stainless Steel SS410
Signal Gearbox	Ductile Iron ASTM A536 65-45-12
O-Ring	EPDM
Bushing	Bronze ASTM B150M C63000
Gland	Galvanized Carbon Steel Surface Passivation
Washer	Galvanized Carbon Steel Surface Passivation
Plug	Galvanized Carbon Steel Surface Passivation
Gear Box Fasteners	Galvanized Carbon Steel Surface Passivation

### DIMENSIONS (mm)

Size	50	65	80	100	125	150	200	250	300
	2	2½	3	4	5	6	8	10	12
<b>A</b>	140.5	152.5	157.5	176	191	202.5	243.5	273	311
<b>B</b>	78	78	85	105	128	140	170	205	258
<b>C</b>	43	46	46	52	56	56	62	68	78
<b>F</b>	47.2	50.2	50.2	58	62	62	70	76	86
<b>ØD</b>	150	150	150	150	200	200	350	350	350
<b>E</b>	159	159	159	159	159	159	235	235	235
<b>H</b>	175.5	187.5	192.5	211	226	237.5	281	310.5	348.5

### NET WEIGHT (kg) & CRATE QTY (pcs)

Size	2"/50	2.5"/65	3"/80	4"/100	5"/125	6"/150	8"/200	10"/250	12"/300
<b>N.W.</b>	6.7	7.6	8.1	11.7	15.3	17.9	23.7	32.8	45.3
<b>Crate Qty</b>	60	60	60	40	30	30	20	20	10