

BRASS BALL VALVE

PN25 F4B25



FEATURES & SPECIFICATIONS

- Threaded body cap
- Blow-out proof stem
- Threaded to BS EN 10226-1 (ISO 7)
- Applicable for Building Services, Air-Conditioning, Fire-Protection, Cold Water Plumbing, Hot Water System, General Industries

PRESSURE & TEMPERATURE RATINGS

Working Pressure	25bar WOG Non-Shock 10bar Saturated Steam
Shell Testing Pressure (x1.5)	37.5bar Hydrostatic
Seat Testing Pressure (x1.1)	27.5bar Hydrostatic 5.5bar Air
Working Temperature	-10°C ... 170°C
Suitable Media	Water, Oil & Gas



MATERIAL SPECIFICATIONS

Part	Material	Specification
Body	Brass	EN 12165 CW617N
Ball	Brass	EN 12165 CW617N
Stem	Brass	EN 12165 CW617N
Seat	PTFE	
Seat Retainer	Brass	EN 12165 CW617N
Packing	PTFE	
Gland Nut	Brass	EN 12165 CW617N
Lever Nut	Stainless Steel	
Lever	PVC Covered mild steel	

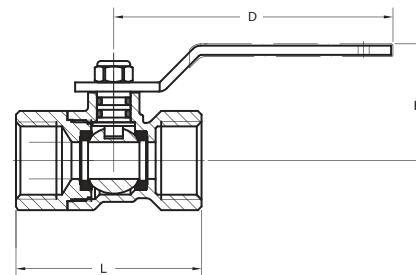

DIMENSIONS

DN (mm)	10	15	20	25	32	40	50	(mm)
DN (inch)	3/8	1/2	3/4	1	1 1/4	1 1/2	2	
L	46	50.5	59.5	67	78	88	99	
H	33	33	40	44	58	63	76	
D	76	76	94	94	120	120	152	