

BRONZE BALL VALVE

PN25 F4G25



FEATURES & SPECIFICATIONS

- Threaded body cap
- Blow-out proof stem
- Threaded to BS EN 10226-1 (ISO 7)
- Applicable for Building Services, Air-Conditioning, Fire-Protection, Cold Water Plumbing, Hot Water System, General Industries



PRESSURE & TEMPERATURE RATINGS

Working Pressure	25bar WOG Non-Shock 10bar Saturated Steam
Shell Testing Pressure (x1.5)	37.5bar Hydrostatic
Seat Testing Pressure (x1.1)	27.5bar Hydrostatic 5.5bar Air
Working Temperature	-10°C ... 170°C
Suitable Media	Water, Oil & Gas



MATERIAL SPECIFICATIONS

Part	Material	Specification
Body	Bronze	EN 1982 GC CC491K
Ball	Brass	EN 12165 CW617N
Stem	Brass	EN 12165 CW617N
Seat	PTFE	
Seat Retainer	Bronze	EN 1982 GC CC491K
Packing	PTFE	
Gland Nut	Brass	EN 12165 CW617N
Lever	PVC Covered Mild Steel	

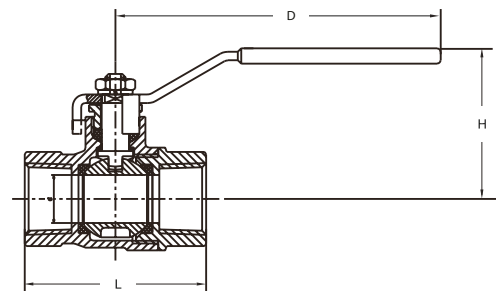

DIMENSIONS

DN	15	20	25	32	40	50	65	80	100
(mm)	15	20	25	32	40	50	65	80	100
(inch)	½	¾	1	1¼	1½	2	2½	3	4
L	54	61	71	85	92	114	134	152	182
H	50	53	57	67	72	82	118	132	150
D	95	110	110	137	137	160	220	270	280

Fivalco® is Registered Trade Mark
FIVALCO LIMITED
 info@fivalco.com | www.fivalco.com

Exclusive Distributor:
ENVALCO SDN. BHD. (1039097-M)
 No. 30, Jalan PJU 3/46, Sunway Damansara Technology Park, 47810 Petaling Jaya, Selangor Darul Ehsan, Malaysia
 T: 603 - 7883 0018 | F: 603 - 7883 0012 | E: enquiry@envalco.com.my | W: www.envalco.com.my

Fivalco reserves the right to alter the information in this document without prior notice. Fivalco shall not be liable for technical errors or omissions contained herein.