

# FOOT VALVE

PN16 F53F16  
PN25 F53F25



## FEATURES & SPECIFICATIONS

- Spring loaded
- Rubber seat ring for non-slam effect
- Perforated stainless steel screen
- Durable fusion bonded epoxy coated
- Flange drilled to BS 4504 PN16 / EN 1092-2 PN16 / BS 4504 PN25 / EN 1092-2 PN25 ANSI Class 150 (Specify on order)
- Applicable for Building Services, Air-Conditioning, Fire Protection, Cold Water Plumbing, Hot Water System, General Industries.



## PRESSURE & TEMPERATURE RATINGS

Working Pressure	16bar	25bar
Shell Test Pressure (x1.5)	24bar	37.5bar
Seat Test Pressure (x1.1)	17.6bar	27.5bar
Working Temperature	-20°C ... 110°C (EPDM Seat Ring) -10°C ... 80°C (NBR Seat Ring)	
Suitable Media	Water	

## MATERIAL SPECIFICATIONS

Part	Material	Specification
Body	Ductile Iron	EN-JL 1050
Disc	Ductile Iron	EN-JL 1050
	Stainless Steel 304	EN 10088-3 1.4301
	Aluminium Bronze	EN 1982 CB491K
Seat	Ductile Iron	EN-JL 1050
	Stainless Steel 304	EN 10088-3 1.4301
	Aluminium Bronze	EN 1982 CB491K
Seat Ring	EPDM	
	NBR	
Spring	Stainless Steel 304	EN 10088-3 1.4301
Screen	Stainless Steel 304	EN 10088-3 1.4301

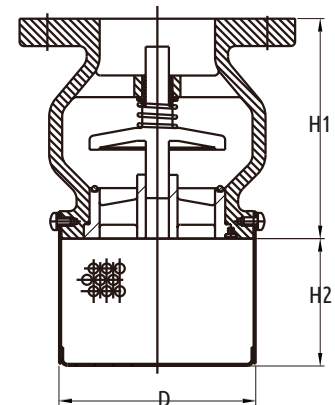

## DIMENSIONS

DN (mm)	50	65	80	100	125	150	200	250	300	350	400	450	500	600
DN (inch)	2	2½	3	4	5	6	8	10	12	14	16	18	20	24
H1	133	140	152	185	216	229	257	293	362	400	448	476	524	610
H2	68	93	108	138	163	189	208	225	245	270	290	315	340	365
D	114	130	144	177	203	237	290	330	383	470	520	570	630	740

Fivalco® is Registered Trade Mark  
**FIVALCO LIMITED**  
info@fivalco.com | www.fivalco.com

Exclusive Distributor:  
**ENVALCO SDN. BHD.** (1039097-M)  
No. 30, Jalan PJU 3/46, Sunway Damansara Technology Park, 47810 Petaling Jaya, Selangor Darul Ehsan, Malaysia  
T: 603 - 7883 0018 | F: 603 - 7883 0012 | E: enquiry@envalco.com.my | W: www.envalco.com.my

Fivalco reserves the right to alter the information in this document without prior notice. Fivalco shall not be liable for technical errors or omissions contained herein.