

FEATURES & SPECIFICATIONS

- Senses to open at low pressure before surge and quick relief high pressure wave
- Pre-open function eliminates the surge with pump abrupt stoppage
- The high pressure pilot opens the valve to releases excessive system pressure
- Full bore globe pattern design for superior control characteristic
- Nylon reinforced diaphragm for long-lasting performance
- Durable fusion bonded epoxy coated
- Flange drilled to EN 1092-2 PN16 / EN 1092-2 PN25 / ANSI Class 150
- Design comply with EN 1074 -5



PRESSURE & TEMPERATURE RATINGS

Working Pressure	16bar	25bar
Shell Test Pressure (x1.5)	24bar	37.5bar
Seat Test Pressure (x1.1)	17.6bar	27.5bar
Working Temperature	-20°C ... 110°C (EPDM) -10°C ... 80°C (NBR)	
Suitable Media	Water	

MATERIAL SPECIFICATIONS

Part	Material	Standard
Body	Ductile Iron	EN-JS 1050
Bonnet	Ductile Iron	EN-JS 1050
Plug	Stainless Steel 304	AISI 304
Stem	Stainless Steel 304	AISI 304
Seat	Stainless Steel 304	AISI 304
Seat Retainer	Stainless Steel 304	AISI 304
Spring	Stainless Steel 304	AISI 304
Diaphragm	Nylon Reinforced Rubber	EPDM + Nylon Fabric
Seal Ring	Rubber	EPDM
O-Ring	Rubber	NBR

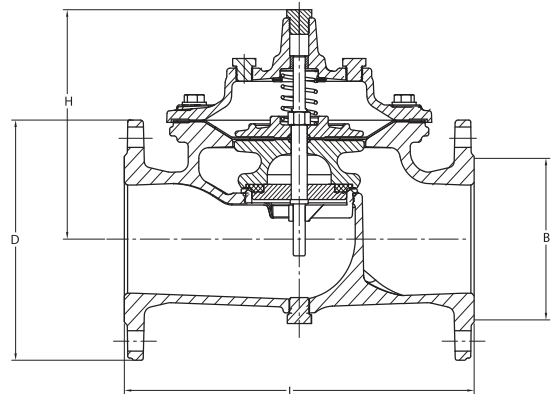

DIMENSIONS

DN	(mm)	50	65	80	100	125	150	200	250	300	(mm)
	(inch)	2	2½	3	4	5	6	8	10	12	
L		230	290	310	350	400	480	600	730	850	
H		177	202	219	243	243	333	428	478	538	
D		165	185	200	220	250	285	340	405	460	
B		99	118	132	156	156	211	266	319	370	

SURGE ANTICIPATING VALVE

PN16 F6316-PSA
PN25 F6325-PSA



PILOT VALVE SPECIFICATION

No.	Description	Material
1	Cap	ABS Plastic
2	Adjusting Screw	Stainless Steel 304
3	Jam Nut	Stainless Steel 304
4	Spring Table	Stainless Steel 304
5	Bonnet	Stainless Steel 304
6	Spring	Spring Steel
7	Nut	Stainless Steel 304
8	Spring Table	Spring Steel
9	Fixing Holder	Stainless Steel 304
10	Screw	Stainless Steel 304

No.	Description	Material
11	Diaphragm	Nylon Reinforced + NBR
12	Yoke	Stainless Steel 304
13	Body	Stainless Steel 304
14	Disc	Stainless Steel 304 + EPDM
15	O-Ring	NBR
16	Plug	Stainless Steel 304
17	Internal Body	Stainless Steel 304
18	O-Ring	NBR
19	O-Ring	NBR

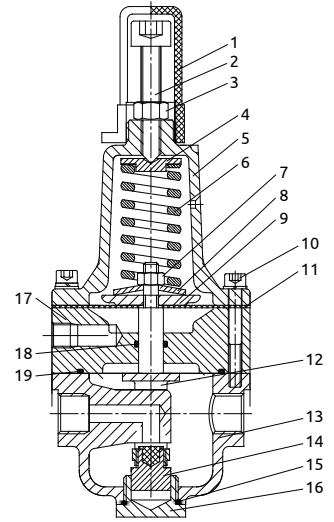

VALVE COMPOSITION

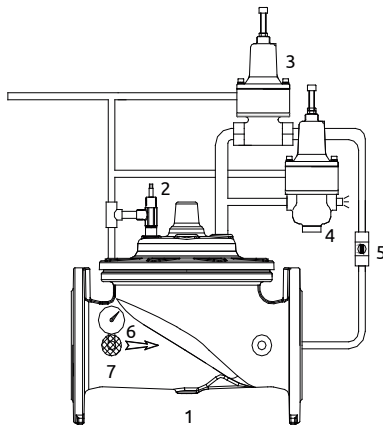

1	Main Valve
2	Needle Valve
3	Pilot Valve (P500)
4	Pilot Valve (P20A)
5	Ball Valve
6	Inlet Pressure Gauge
7	Strainer

TYPICAL CONNECTION

